



Section 18, T. 19, R. 17,

Scale 300 Feet = 1 Inch.

LICKING CO.

PERRY CO.

We, the undersigned, members of the Canal Commission of the State of Ohio, do hereby certify that this map was made under our direction and in conformity to instructions prepared by the Chief Engineer of the Board of Public Works of said State, and we hereby approve the same.

Witness our hands this 16th day of ^{Nov} 1892.

David Starbuck
Canal Commissioner,

John Myers
Chief Engineer of Board of Public Works of the State of Ohio, hereby approve of this map.

John Myers
Chief Engr. P.P.W.

Columbus, Ohio February 9th 1892.

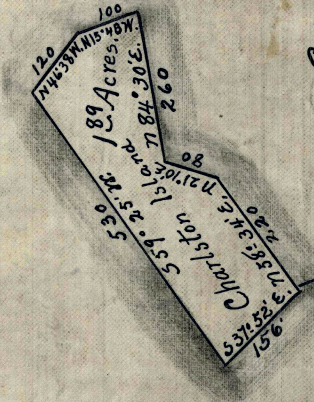

Scale 300 Feet = 1 Inch.